



Actuator for swing gates up to 600 lbs weight and 16 ft length. Recommended for residential, farm and ranch applications.



Versatile: available in both 1500 single version and 1600 dual gate version, including an additional actuator with 38 ft. cable working with the Apollo 636 circuit board.

Solar compatible: optional 12 V battery (required) can be charged by either solar or AC power. The choice is yours!

Reliable in any condition: in the event of electrical power outage or significantly overcast days, a fully charged deep cycle marine battery (recommended) will provide up to 300 cycles or 30 days usage on a basic system before requiring a recharge.

Easily installed on most existing or new gates; practical external adjustment of the limit switches.

- Intelligent,** thanks to the smart Apollo 635/636 circuit board features:
- Automatic adjustable close timer;
 - Adjustable current sensitivity for automatic safety reverse;
 - Inputs for: exit, hold open and under gate loops, safety edges, free exit, probes, keypads, telephone entry systems, intercom systems, pushbuttons, locks, radio receivers;
 - Fully systems capable.

The ideal solution for special applications: both operator models can be used in **push to open or pull to open mode**, thus increasing the flexibility of having the actuator inside or outside the gate, regardless of hinge left or right or direction of gate swing. The direct drive system attaches directly to the gate.

Quality and durability to corrosion thanks to the housing, weather resistant NEMA 3R, powder coated black. The actuator has rust proof linear acme screw drive and self-lubricating gears. Supplied with 8 ft. (2.4m) of cable.

Code	Description
1500	Operator 12 Vdc for swing gates up to 16 ft. and 600 lbs. each, single gate version, 635 circuit board.
1600	Operator 12 Vdc for swing gates up to 16 ft. and 600 lbs. each, dual gate version, 636 circuit board.

Technical specifications

Code	1500	1600
Electrical data		
Operation (Vdc)	12	
Absorption - standby (mA)	10	
Performance data		
Speed open 90° (s)	14-16	
Duty Cycle (cycles/hour)	Varies based on charging capacity	
Dimensional and general data		
Working Temp (°F Min/Max)	-40 ÷ +150	
Dimensions - Control box (inches)	18x18x8	
Dimensions - Actuator (inches)	42 retracted - 66 extended	

Gate setup

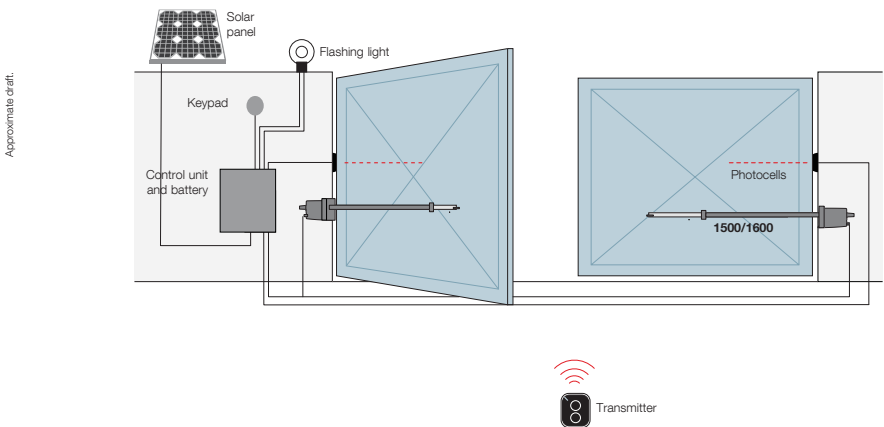

Nice accessory for a safe automation system:



LP1 - LP2 Loop detectors.

Dimensions

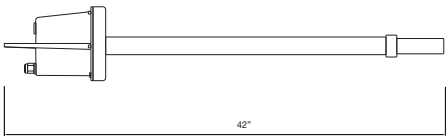

Application



A safe choice, reliable in any condition. Sturdy, for swing gates up to 600 lbs and 16 ft.